

## Welcome to the Hartlands Alberts Pad apartment

### LIGHTS

1. Motion detectors in the corridor will automatically turn the lights on for a few minutes, please do not press them.

### THE TV & YOUVIEW CONTROLS



### TV INPUT

Press the button labelled 'Source' on the TV Remote, and then select your input source using the 'Up Arrow' & 'Down Arrow'.

Select 'HDMI1/DVI' for the Free View Television box

Select 'PC' for the Computer

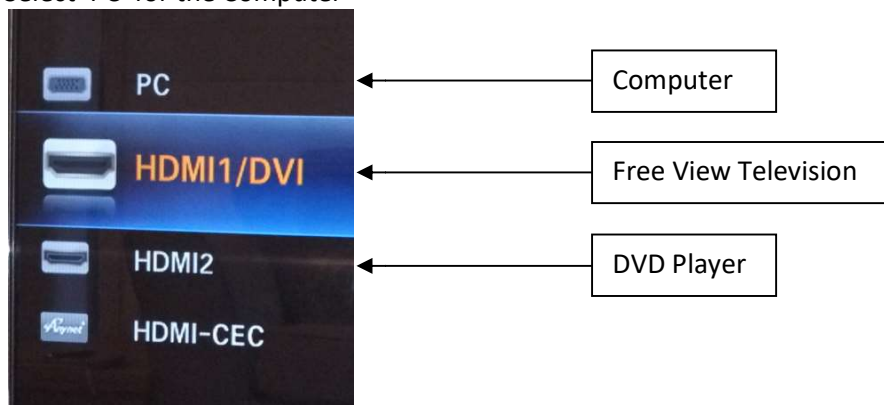



## **COOKING WITH THE HOB**

1. Press the  button to turn on the controls.
2. Use the number buttons to select the heat '0 1 2 3 4 5 6 7 8 9 P'
3. Use the + and - buttons to set a timer



*NOTE: These hobs can heat very quickly; do not leave anything unattended whilst on the hob*

## **USING THE HOB TIMER**

1. Select a Hob with one of the  buttons
2. Press the  button
3. Use the + and - buttons to set the minutes for the timer

*NOTE: Once the timer is on, it will turn off automatically. This will not affect the other 3 Hobs.*

## **CHILD SAFETY ON THE HOB**

1. Press and hold the  button at any time to activate/deactivate Hob child lock.
2. When activated the only button that will work is the  button which will turn off all hobs.
3. Removing a pan from the hob will disconnect the heating element, place pan again to continue cooking.

## **COOKING WITH THE OVEN**

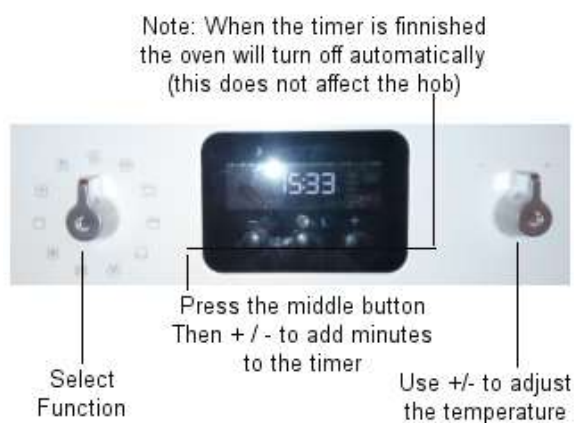

*NOTE: The oven door has a safety latch (top right of the door). Simply lift the latch to open the door.*

## **CHILD SAFE KNIFE BLOCK**

The knife block has a child lock keeping them in place; pull up the button on the sides to release the knives.