

Welcome to the Hartlands Emily Cottage apartment

LIGHTS

1. Motion detectors in the corridor will automatically turn the lights on for a few minutes, please do not press them.
2. The bedrooms and lounge have touch sensitive light switches.
 - a. Tap the switch to turn these lights on/off.
 - b. Touch and hold the switch to cycle through from bright to dim.
3. The bathroom mirrors touch sensitive light switches at the base. Touch the switch on the mirror to turn these lights on; they will turn themselves off after a few minutes.

NOTE: If the lights seem not to be working, they may just be set to their dimmest setting, touch and hold to bring them back up to a brighter setting.

THE TV & YOUVIEW CONTROLS

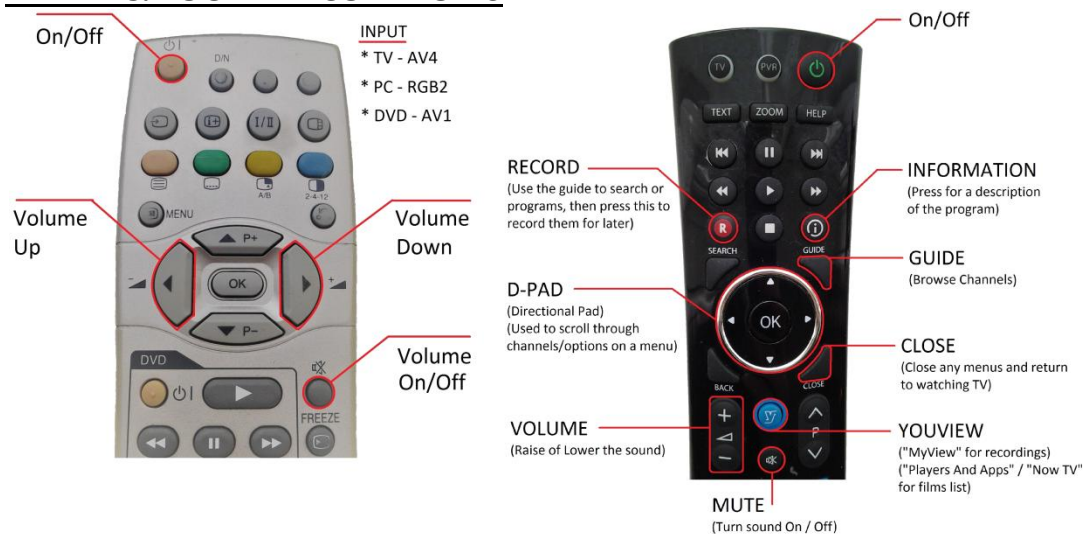



TV INPUT

Press the button labeled **"AV4"** on the TV remote to watch **Sky TV** programs
Press the button labeled **"AV1"** on the TV remote to watch the **DVD** player
Press the button labeled **"RGB2"** on the TV remote to watch **Computer** films

TIPS



1. NO PICTURE?
 - If the TV and Sky TV box are on but there is no picture, try pressing "**AV4**" at the bottom of the TV remote.
2. REMOTE NOT WORKING?
 - If the SKY remote isn't working, try pressing the button at the top centre of the remote labeled "PVR"

COOKING WITH THE HOB

1. Press the  button to turn on the controls.
2. Choose one of four Hobs with the  buttons
3. Use the + and - buttons to raise or lower the temperature (1 = low 9 = high P = highest)



NOTE: These hobs can heat very quickly; do not leave anything unattended whilst on the hob

USING THE HOB TIMER

1. Select a Hob with one of the  buttons
2. Press the  button
3. Use the **+** and **-** buttons to set the minutes for the timer

NOTE: Once the timer is on, it will turn off automatically. This will not affect the other 3 Hobs.

CHILD SAFETY ON THE HOB

- 1: Press and hold the  button at any time to activate/deactivate Hob child lock.
- 2: When activated the only button that will work is the  button which will turn off all hobs.
- 3: Removing a pan from the hob will disconnect the heating, place pan again to continue cooking.

COOKING WITH THE OVEN

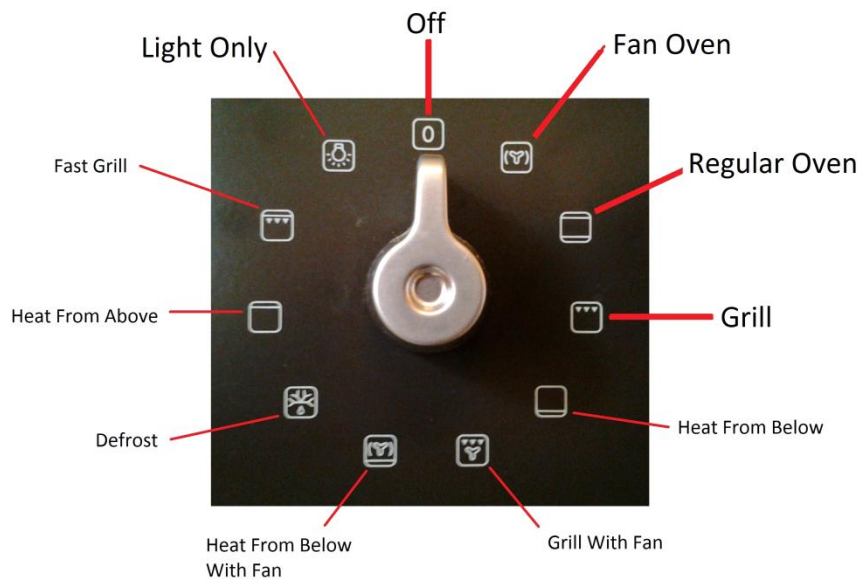

**NOTE: When the timer is finished
the oven will turn off automatically
(This does not effect the hob)**



Select Funtion

Press the middle button
then + / - to add minutes
to the timer

Use + / - to adjust
temperature

NOTE: The oven door has a safety latch (top right of the door). Simply lift the latch to open the door.

CHILD SAFE KNIFE BLOCK

The knife bock has a child lock keeping them in place; pull up the button on the sides to release the knives.